

NOTES:

1. ALL DISTANCES SHOWN ARE HORIZONTAL GROUND DISTANCES.
2. THIS PROPERTY IS LOCATED IN FLOOD ZONE "X" AS SHOWN ON FEMA MAP PANELS 3720799400K & 3720799500L, DATED DECEMBER 21, 2018 AND SUBJECT TO CHANGE BY FEMA.
3. IT IS THE RESPONSIBILITY OF THE CONTRACTOR/OWNER TO VERIFY ALL BUILDING SETBACKS (MBL) AND RESTRICTIVE COVENANTS PRIOR TO CONSTRUCTION.

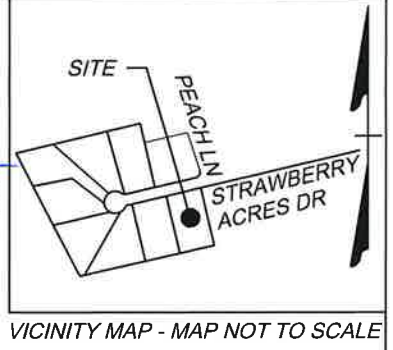

THIS IS A SITE PLAN ONLY (NOT A SURVEY) BASED ON RECORDED INFORMATION AND DESIGN PLANS PROVIDED BY CONTRACTOR

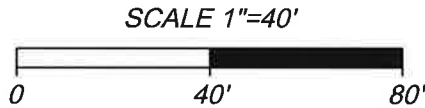

MINIMUM FINISHED FLOOR ELEVATION	
LOT	ELEVATION
19	13.9

OPEN SPACE
STRAWBERRY ACRES
PHASE 2
M.B. 65, PG. 42

OPEN SPACE
STRAWBERRY ACRES
PHASE 3
M.B. 72, PG. 34
S77°03'13"W 160.22'

LOT 15
STRAWBERRY ACRES
PHASE 2
M.B. 65, PG. 42

19
43,000 SF

20



S13°07'43"E 268.57'

N13°07'43"W 268.17'

10' SIDE MBL (TYP)

R-35A ZONE
BUILDING SETBACK (MBL)
40' FRONT
10' SIDE
30' REAR

M.B. 76, PG. 37
DRAINAGE & UTILITY EASEMENTS
20' FRONT
10' SIDE & REAR

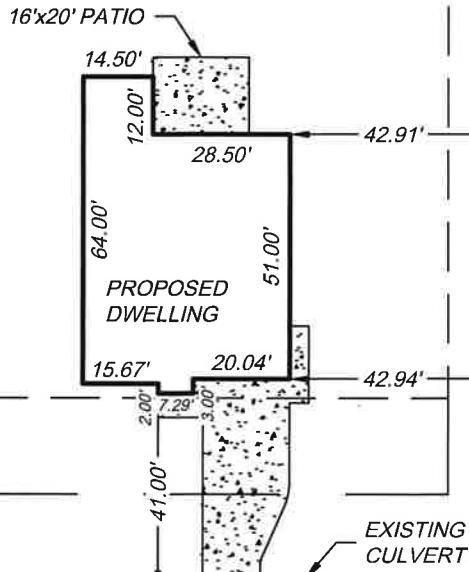

S76°54'38"W 160.22'

STRAWBERRY ACRES DRIVE (50' R/W)

LEGEND

- PROPERTY CORNER
- PROPERTY BOUNDARY
- ADJACENT PROPERTY LINES
- RIGHT-OF-WAY
- BUILDING SETBACK (MBL)
- DRAINAGE EASEMENT

**SITE PLAN FOR
WETHERINGTON, INC.**

BEING LOT 19, STRAWBERRY ACRES - PHASE 4, M.B. 76, PG. 37

THIS DRAWING PREPARED AT THE
ELIZABETH CITY OFFICE
1805 West City Drive, Unit E | Elizabeth City, NC 27909
TEL 252.621.5030 www.timmons.com C-1652

YOUR VISION ACHIEVED THROUGH OURS.

Providence Township	Pasquotank County
Date: April 07, 2026	Scale: 1" = 40'
Sheet 1 of 1	J.N.: 55286.039
Drawn by: J. Sawyer	Checked by: J. Mizelle